



Instruction Manual

GALAXY 2-IN-1 RECHARGEABLE STICKVAC (22.2V)



Model: VGALAXY

Content

Proper use _____	2
Safety notes _____	3
Product contents and device overview _____	6
Before first use _____	7
Charging the rechargeable battery _____	7
Operation _____	8
Cleaning and storage _____	9
Troubleshooting _____	10
Technical data _____	10
Disposal _____	11
Warranty statement _____	12

Explanation of symbols



Safety instructions:

Please carefully read through and obey the safety notes in order to avoid injury to persons and damage to property.



Supplementary information

Dear customer,

We are delighted that you have decided on this battery-operated handheld vacuum cleaner.

Before using the device for the first time, please carefully read through the instructions and store them for future reference. These instructions are to accompany the device when passed on to others.

The manufacturer and importer assume no liability in the event the data in these instructions have not been observed!

Please note: The illustrations in these instructions may vary slightly from the real device.

Proper use

- This device is intended for vacuum cleaning dry surfaces.
- Do not in any case vacuum up the following:
 - smouldering ashes, cigarette butts, matches etc.,
 - Flammable or ignitable materials,
 - very fine dust (e.g. cement dust), ash or toner,
 - pointy, hard objects such as larger glass shards,
 - liquids or wet dirt.
- The device is intended for domestic, not commercial use.
- Only use the device as described in this instruction manual. Any other use is deemed improper.
- Defects arising due to improper handling, damage or attempts at repair are excluded from the warranty. This also applies to normal wear and tear.

Safety notes

- This appliance is not intended for use by persons (including children) with reduced physical, sensory or mental capabilities, or lack of experience and knowledge, unless they have been given supervision or instruction concerning use of the appliance by a person responsible for their safety.
- Children should be supervised to ensure that they do not play with the appliance.
- Cleaning and user maintenance may not be carried out by children
- Children younger than 8 years of age and animals must be kept away from the device and the connecting cable!
- Children must be supervised to guarantee that they do not play with and/or injure themselves on the device.
- Only use and store the device out of the reach of children and animals. Improper use may result in injury and electrical shock. The mains cable must also be kept out of the reach of children and animals.
- The device must always be disconnected from the mains power when it is left unattended and before assembling, disassembling or cleaning the device.
- Only charge the rechargeable battery with the enclosed mains adapter and the charging station. Do not charge any devices other than the handheld vacuum cleaner. with the the enclosed mains adapter and the charging station.
- Never immerse the device, mains cable or plug in water or other liquids and ensure that they cannot fall into water or become wet.
- If the device, the connecting cable or the plug of the device is damaged, it must be replaced by the manufacturer or customer service department or a similarly qualified person (eg. specialist workshop) in order to avoid any hazards.



Risks of injury

- Keep children and animals away from the device and packaging material. There is a danger of injury and suffocation!
- Do not use the device if it is damaged.

- During use, keep the nozzles away from body parts and pets. They could be caught in the vacuum cleaner. If the vacuum cleaner attaches itself when vacuuming, turn it off immediately with the On/Off switch.



Risk of electric shock and fire

- Only connect the mains adapter to a properly installed socket with protective earth contacts. The socket must also be easily accessible after connecting so that the mains connection can be quickly disconnected. The mains voltage must correspond to the technical data of the device. Only use proper extension cords, whose technical data correspond to those of the device or mains adapter.
- If the device falls in water, immediately disconnect the power supply. Do not attempt to pull the device out of the water when it is connected to the mains supply.
- Never touch the device, the mains cord and the mains adapter with wet hands when these components are connected to the mains supply.
- Turn the device off and pull the mains adapter out of the socket
- if you stop working with it, if an error or fault occurs during operation, if foreign objects penetrate the device.
- Do not use the device if it is still connected to the mains adapter or to the power source.
- Always pull on the mains adapter and never on the mains cord.
- Only use the device in enclosed areas.
- Do not use the device in rooms containing easily flammable dust or toxic and explosive vapours.
- Do not operate the device in very moist environment or in the vicinity of flammable material.
- For your own safety, always check the device for damages prior to using it. Only use the device if the device, the rechargeable battery, mains cord and the plug do not exhibit any damages.



Danger from Rechargeable Batteries

- Rechargeable batteries can be deadly if swallowed. Seek medical attention immediately if a battery has been swallowed.
- Before inserting the battery pack, check whether the contacts are clean and clean them if necessary.
- Use only the battery type specified in the technical data.
- If the battery has leaked, do not allow your skin, eyes and mucous membranes to come into contact with the battery acid. If you touch battery acid, rinse the affected sites with abundant fresh water immediately and contact a doctor as soon as possible.
- Remove a leaking battery from the device immediately. Clean the contacts before inserting a new battery.
- The battery must not be taken apart, thrown into a fire, immersed in liquids or short-circuited.



Avoiding damage to materials, property and the device

- Always place the device on a dry, level, firm and heat resistant surface.
- Lay the cable of the mains adapter so that it does not pose a tripping hazard.
- Make sure that the mains cord does not get pinched, kinked or laid over sharp edges and does not come into contact with hot surfaces.
- Maintain adequate distance to heat sources such as stoves or ovens to prevent damage to the device. Do not place any open flames, e.g. burning candles, in the direct vicinity of the device, cord, rechargeable battery and mains adapter.
- Do not allow the device to fall and do not subject it to strong percussions.
- Do not pull or carry the device by the cord of the mains adapter.
- Do not subject the device to extreme temperatures, severe changes in temperature, moisture, wetness or direct sunlight.
- Do not use any corrosive or abrasive cleaning agents to clean the device. They could damage the surface.
- Only use the device if it has been completely and correctly assembled! The dust bin and filter must be in place. The filters may not be damaged!
- Do not insert anything in the openings / nozzles of the device and make sure that they are not plugged.
- Empty the dust bin after every use. The filters must also be cleaned regularly to prevent the motor from being overloaded.
- Only use the accessories recommended by the manufacturer.

Product contents and device overview

Device



- 1 Charge control light
- 2 On/Off switch
- 3 Motor assembly/main unit
- 4 Rechargeable battery (removable)
- 5 Dust bin lid
- 6 Dust filter (located inside of the dust bin)
- 7 Dust bin
- 8 Suction opening



- 9 Powered floor brush
- 10 Brush nozzle
- 11 Crevice nozzle
- 12 Nozzle adapter (to be used with brush nozzle and crevice nozzle)
- 13 Mains adapter



Not shown

- HEPA filter (in the dust filter)
- Charging station
- Current carrying tube

Accessories

Floor nozzle

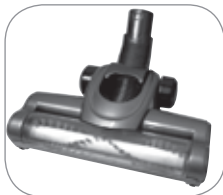

The floor nozzle is suitable both for carpets and smooth floors.

Tile nozzle



Use the crevice nozzle to vacuum up dirt and dust. It is suitable for cushions, cleaning the inside of cars and is perfect for hard-to-reach areas like corners or gaps.

Brush nozzle



Use the brush nozzle for all objects, furniture, lamps, window sills, profile strips and skirting boards with uneven surfaces as well as delicate objects like picture frames, lamp shades, keyboards, books etc.

Before first use



ATTENTION!

- Keep children and animals away from the packaging material. Danger of suffocation exists!
-
1. Unpack all parts, remove the foils and transport guards and make sure that the product contents are complete (see chapter “Product contents and device overview”) and check for any damages from transport. If you identify damages to the components, do not use them, instead contact (03) 9460 5655 or email sales@cleanstar.com.au
 2. Charge the rechargeable battery (see chapter “Charging the rechargeable battery”).

Charging the rechargeable battery



ATTENTION!

- Pull the mains adapter out of the socket if you do not use it for a prolonged period of time.
- **Completely charge the rechargeable battery before first use for maximum charge. Charging takes approx. 4 to 5 hours.**
- **If the rechargeable battery is completely depleted after use, it will take approx. 4 to 5 hours to recharge the rechargeable battery.**



1. Remove the rechargeable battery from the device: Push the latch on the rechargeable battery (see photo) and remove it.
2. Insert the rechargeable battery into the charging station.
3. First connect the barrel connector of the mains adapter to the connector jack on the charging station and then to a properly installed, easily accessible socket.
4. The green and the red control light on the charging station will be illuminated. The rechargeable battery will be charged.
5. Let the rechargeable battery of the device charge for approx. 4 to 5 hours in order to reach the maximum charge. If only the green control light is still illuminated, the rechargeable battery has been fully charged.

6. First disconnect the mains adapter from the mains supply and then the barrel connector from the charging station.
7. Remove the rechargeable battery from the charging station and insert it in the device again.

Operation



ATTENTION!

- During use, never hold the nozzles near body parts and do not reach into them. The device could attach itself to them and you could be injured. If the vacuum cleaner attaches itself to the floor, turn it off immediately.
- Keep the nozzles away from animals during use. Do not attempt to vacuum off animals with the device. The device could attach itself to them and injure them.
- Make sure that there are no large, pointy objects on the area to be cleaned.
- Do not in any case vacuum up the following:
 - Smouldering ashes, cigarette butts, matches etc
 - Flammable or ignitable materials
 - Very fine dust (e.g. cement dust), ash or toner
 - Pointy, hard objects such as larger glass shards
 - Liquids and wet dirt
- Empty and clean the dust bin after every use (see chapter “Cleaning and storage”).
- Do not use the device when it is connected to the mains adapter.

1. Stick the nozzle adapter on the suction opening if you want to use the crevice and dusting brush nozzle.
2. If you would like to use the rod, attach the current carrying tube directly to the suction opening (you will not be able to use the current carrying tube and the crevice nozzle or dusting brush at the same time).
3. Attach the powered floor brush to the current carrying tube.



The dusting and brush nozzles attach to the nozzle adapter directly.

4. Turn the device on by pressing and holding the On/Off switch. The device will immediately start to vacuum.
5. Run the device over the area to be cleaned.
6. Turn the device off by releasing the On/Off switch.

Cleaning and storage



ATTENTION!

- Ensure that the device has been deactivated before you clean it!
- Never immerse the device, the mains adapter, the rechargeable battery or the cable in water or other liquids.

- The device may not be connected with the mains adapter when cleaning the dust bin.
- Never use soap or other cleaners to clean the dust and HEPA filter. Otherwise this would damage the filters.
- The filters are not suitable for the washing machine, dishwasher or dryer! Only air dry the filters and do not in any case use a hair dryer.
- Only put the device back together once all parts are completely dry!
- Do not use any corrosive or abrasive cleaners to clean the housing. They could damage the surface. If needed, clean the housing with a damp, soft cloth.

Emptying the dust bin and cleaning the filters

1. Take the dust bin off of the device by turning it approx. one quarter revolution counterclockwise and pulling it out.
2. Push the release button on the dust bin and empty the dust bin over a waste bin.
3. Pull the filters out of the dust bin: Turn the dust filter approx. one quarter turn counterclockwise and remove both filters. Tap out the filters over a waste bin.



4. If necessary, clean the dust bin and the filters with clean, lukewarm water.
5. Allow all parts to dry completely before assembling them.
ATTENTION: Do not in any case insert the filters if they are still moist. Reverse the steps to assemble them. Make sure that the catches on the dust bin are inserted into the corresponding recesses on the main unit. Otherwise, the dust bin will not correctly lock into the device.
6. Store the device and accessories in a dry area out of the sun that is not accessible to children and animals.



If you do not want to use the device for a prolonged period, remove the rechargeable battery to stay on the safe side (see section “Removing the rechargeable battery”).

Troubleshooting

If the device is not working properly, please check whether you are able to rectify the problem yourself first.



Do not attempt to repair a defective device yourself!

Problem	Possible cause/solution
The device only operates slowly or doesn't start.	<ul style="list-style-type: none"> • Is the rechargeable battery empty? Charge it.

Problem	Possible cause/solution
The suction power is weak.	<ul style="list-style-type: none"> • Is the dust bin full? Empty the bin. • Is the filter heavily laden with dirt? Clean it. • Is the suction opening plugged? Turn off the device and remove the blockage. • It is also possible that some particles remain caught in the carpet floor or that they are too large/too heavy for the device to vacuum up. Simply remove the debris by hand.
The device emits dust when vacuuming.	<ul style="list-style-type: none"> • Check whether the dust bin and filters have been properly inserted and if necessary, correct their seating.
The control light doesn't illuminate when the device is connected to the mains supply.	<ul style="list-style-type: none"> • Is the mains adapter properly connected with the socket and the barrel connector with the connector jack on the device? • Is the socket defective? Try another socket. • Check the fuse for your mains connection.

Technical data

Device

Model number:	VGALAXY
Voltage supply:	22.2 V (Li-ion 2000 mAh)
Output:	150 W
Rechargeable battery	
<i>charging time:</i>	approx. 4 – 5 hours
<i>operating time:</i>	approx. 20 – 25 minutes if vacuuming consistently. (when fully charged)

Mains adapter

Input:	100 – 240 V ~ 50/60 Hz
Output:	27 V DC, 400 mA
Safety class:	II 



Disposal



The packaging material is recyclable. Dispose of the packaging in an environmentally-friendly manner and make it available to the collection service for recyclable materials.



Dispose of the article in an environmentally friendly manner. It should not be disposed of in the normal household waste. Please dispose of it at a recycling centre for used electrical and electronic devices. You can obtain more information from your local authorities.



Rechargeable batteries and batteries must be removed and disposed of separately before disposing of the device. To protect the environment, batteries and rechargeable batteries may not be disposed of together with normal household waste. Instead they must be turned in at appropriate collection points. Please also observe applicable statutory provisions regulating the disposal of batteries.

Removing the rechargeable battery



ATTENTION!

- Do not open the rechargeable battery; there is a risk of a short circuit; irritating vapours or corrosive liquids may also be emitted.
- Do not expose the rechargeable battery to intense sunlight, heat or fire; there is a risk of explosion.

This device has a rechargeable battery; it must be removed before disposing of the old device.



1. The rechargeable battery is located on the bottom of the main unit.
2. Push the latch on the rechargeable battery (see photo) and remove it.
3. Dispose of the rechargeable battery in an environmentally-friendly manner (collection points or vendors).



Cleanstar Pty Ltd
ABN: 51 121 002 104 ACN: 121 002 104
59 Radford Road, Reservoir VICTORIA 3073
Phone: (03) 9460 5655 Fax: (03) 9460 5666
Email: sales@cleanstar.com.au Web: www.cleanstar.com.au

CONDITIONS OF WARRANTY

This document outlines the terms and conditions of warranty for your Cleanstar product. This is an important document that should be kept with your proof of purchase documents in a safe place for future reference should you require service for your product.

Thank you for purchasing your new Cleanstar product. We are confident this product will give you trouble-free use and excellent service, provided the operator uses and maintains the product in accordance with the Instruction Manual. Please read the Instruction Manual carefully before using the product for correct operation and maintenance procedures, and store it in a safe place for future reference.

1. This is a parts and labour warranty against faulty or defective parts, materials or workmanship in manufacturing, when the product is used and operated in accordance with the Instruction Manual.
2. This product carries a 12 month (1 year) warranty period that commences from the original date of purchase by the first user/purchaser, and is not transferable.
3. The warranty covers only personal, domestic or household use of the product to remove dry dirt and dust from household carpets, flooring and fabrics.
4. This product is not suitable for commercial or industrial cleaning applications and therefore no warranty applies in this case.
5. This warranty only applies to products purchased and used in Australia.
6. At all times during the warranty period, Cleanstar shall, at its sole discretion, determine whether repair, replacement or refund will apply if the product has a valid warranty claim applicable to it.
7. The repair or replacement of the product under this warranty does not extend the original period of warranty.
8. Please note that this warranty will be voided in the following cases (which are not exhaustive) and the warranty does not apply to the cost of replacing any parts of the product resulting from:

- Accidental damage;
 - Normal wear and tear;
 - Neglect, misuse or physical abuse by the operator, including failure to properly maintain or service;
 - Any alterations, modifications or tampering with the product without the prior written consent of Cleanstar;
 - Incomplete or improper installation;
 - Incorrect, improper or inappropriate operation;
 - Insect or vermin infestation;
 - Power surges, electrical storm damage or incorrect power supply/voltage;
 - Excessive use or use for which this product has not been designed;
 - Vacuuming up water, liquids, toner, powders, glass, hazardous, flammable or corrosive materials, plaster dust, concrete dust and other similar building or construction materials;
 - Failure to comply with the operating instructions contained in the Manual supplied with the product;
 - If the product is rented;
 - If the product is used outside of Australia;
 - If the product was serviced or repaired by anyone other than Cleanstar, or one of Cleanstar's Authorised Service Agents (ASA).
- Cleanstar is unable to accept any responsibility under this warranty for any repair work not carried out by an ASA or from the use of non-genuine parts.

9. This warranty does not cover service calls, travelling time or consumable parts such as belts, dust bags, filters, hose or hose parts, rods and wands, floor tools and accessories, motor brushes and other like consumable items, unless defective in manufacture. In order to prolong the life of accessories and consumables, regular care and maintenance is recommended.
10. Please retain your original proof of purchase which will be required before you can make a claim under this warranty. If proof of purchase can not be provided at the time of a warranty claim or service, any work carried out on the cleaner is chargeable.
11. Any transportation and delivery costs involved in the repair of defective parts shall be borne by the claimant. In all instances, unless the product is transported by Cleanstar or a Cleanstar authorised representative, the product is transported at the owner's cost and risk while in transit to and from Cleanstar or its ASA.

Our goods come with guarantees that cannot be excluded under the Australian Consumer Law. You are entitled to a replacement or refund for a major failure and for compensation for any other reasonably foreseeable loss or damage. You are also entitled to have the goods repaired or replaced if the goods fail to be of acceptable quality and the failure does not amount to a major failure. The benefits conferred by this warranty are in addition to other rights and remedies under law in respect of the product to which this warranty relates.

TO INQUIRE ABOUT MAKING A CLAIM UNDER THIS WARRANTY, PLEASE FOLLOW THESE STEPS:

- a) carefully check the Instruction Manual and the terms of this warranty;
- b) have the name and model number of the appliance available;
- c) have the proof of purchase available (ie. invoice, receipt, etc) showing where the appliance was purchased from and date of purchase;
- d) call Cleanstar on (03) 9460 5655 to speak to one of our customer service staff.